

# BP Series / MU Series Multipoint Trim



BP Plate



MU Plate

## Door Configuration

Lever to the Closest Thru-Bolt Center to Center Distance (CTC) Covering Range: 1-3/8"~3-3/8"(35mm~86mm)

Cylinder to the Closest Thru-Bolt Center to Center Distance (CTC) Covering Range: 1-1/2"~2-9/16"(38mm~65mm)

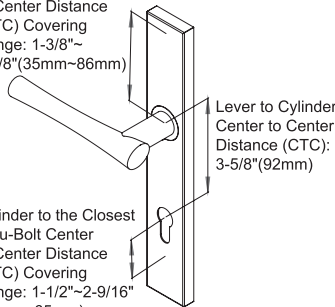

Lever to Cylinder Center to Center Distance (CTC): 3-5/8"(92mm)

## Escutcheon Plates

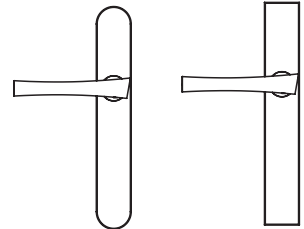

BP Plate

MU Plate

## Standard Specification

- Door Thickness: 1-3/4" with lockcase in the center of the door. Thick Door Kits available on requests.
- Cylinder to Lever Center Distance: 3-5/8" (92mm)
- Spindle: 8x8mm Square.
- Faceplate and strike plate with square corners. Radius corners available on request.
- Schlage C Keyway 5-pin Cylinder, 2 keys included. Keying service available.

## Material

Stainless Steel Levers and Escutcheons

## Levers

All INOX Stainless Steel lever designs

## Finish

- 630 Satin Stainless Steel (US32D)
- 629 Bright Polished Stainless Steel (US32)
- Two-tone Stainless Steel (SP)
- 613 Oil Rubbed Bronze on Stainless Steel (10B) on selected lever designs

\* See page 2.1 for finish availability.

## Application

For swing door Multipoint Point locking system.

## Features

- Bi-direction sprung levers prevent sagging.
- Multiple fixing distance for thru-bolts on the same plate to fit majority of manufacturer's door prep with concealed Fixing.
- Schlage C Keyway for both American or Euro Profile Cylinder.

## Functions

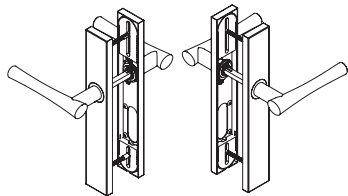

**MA10:**  
Passage Function  
Both outside and inside levers are active.  
No deadlock.

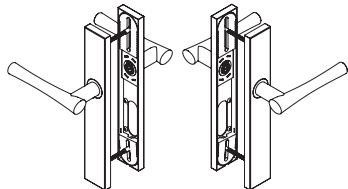

**MA20:**  
Half Passage,  
Half Dummy,  
Outside lever is inactive,  
Inside lever is active.

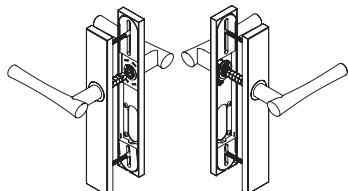

**MADP:**  
Full Dummy  
Both outside and inside levers are inactive.

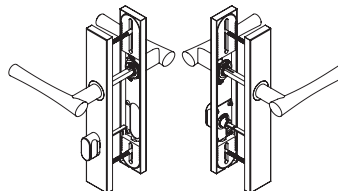

**MA15:**  
Patio Function for Locks using Tailpiece Hub  
Both outside and inside levers are active. Inside thumb-turn locks deadbolt using tailpiece.

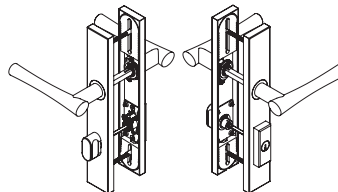

**MA55:**  
Entry Function for Locks using American Cylinder.  
Both outside and inside levers are active. Key from outside and thumb-turn on inside locks the deadbolt, using American cylinder with tailpiece.

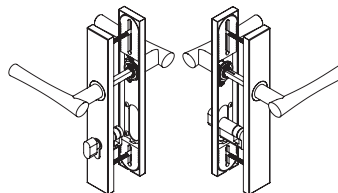

**MA25:**  
Patio Function for Locks using Euro-profile Cylinder  
Both outside and inside levers are active. Inside thumb-turn locks deadbolt using Euro cylinders with cam.

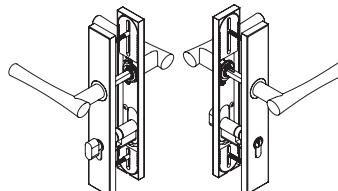

**MA35:**  
Entry Function for Locks using Euro-profile Cylinder  
Both outside and inside levers are active. Key from outside and thumb-turn on inside locks the deadbolt, using Euro cylinders with cam.