

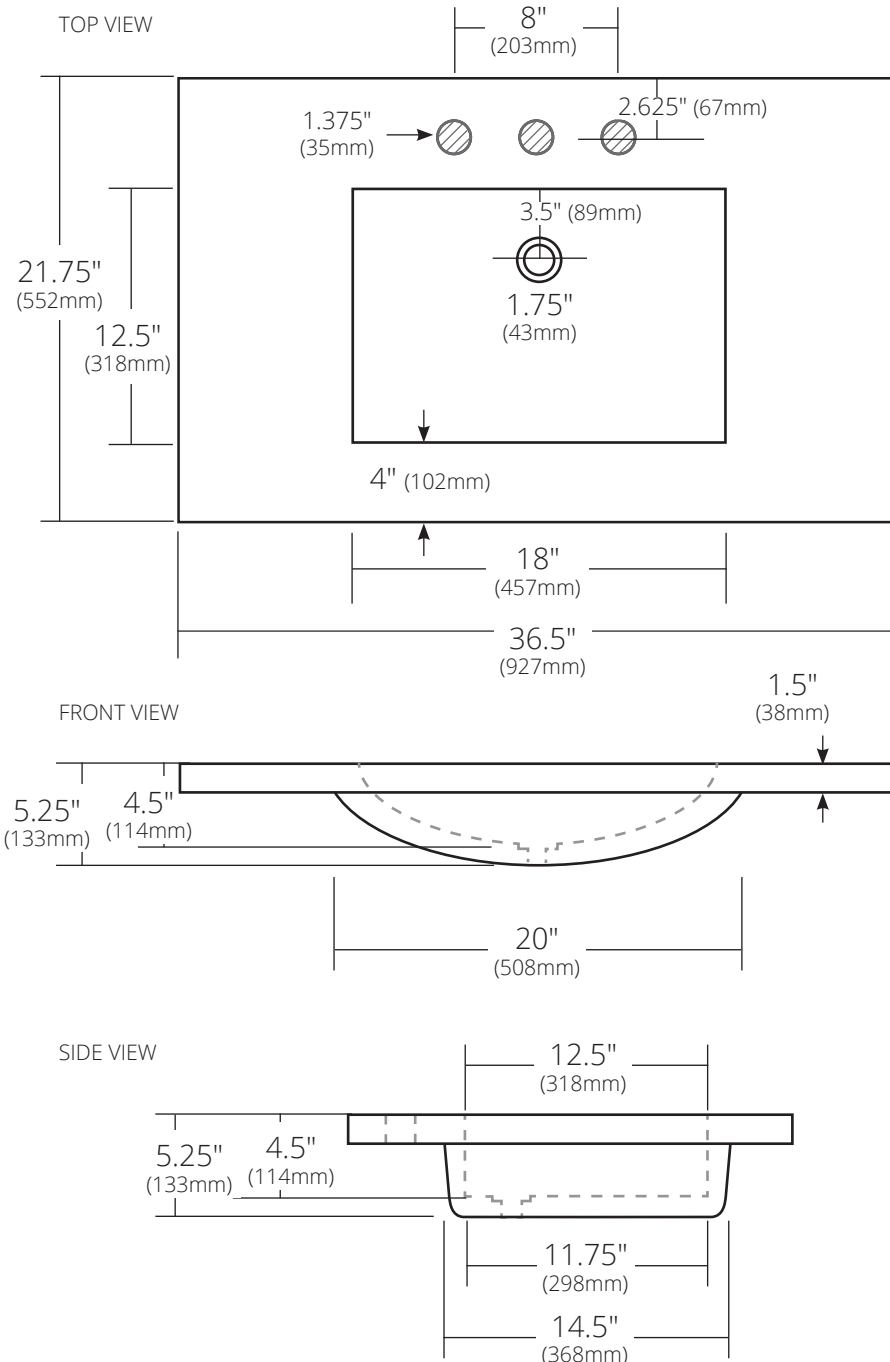



## SPECIFICATIONS

# 36" PALOMAR VANITY TOP WITH INTEGRAL SINK

NativeStone® Collection



			
<b>8" Faucet Spread</b>			<b>Single Faucet Hole</b>
NSVNT36-A Ash			NSVNT36-A1 Ash
NSVNT36-C Charcoal			NSVNT36-C1 Charcoal
NSVNT36-E Earth			NSVNT36-E1 Earth
NSVNT36-P Pearl			NSVNT36-P1 Pearl
NSVNT36-S Slate			NSVNT36-S1 Slate

### PRODUCT DETAILS

- 36.5" x 21.75" x 5.25" OD (927mm x 552mm x 133mm)
- Basin 18" x 12.5" x 4.5" (457mm x 318mm x 114mm)
- 1.75" (43mm) drain opening
- Pre-drilled for 8" (203mm) faucet spread or single faucet hole
- Handcrafted from sustainable NativeStone
- Sealed with NativeStone Shield™

### COORDINATING PRODUCTS

- Drains: DR120, DR130 or DR150

### STANDARDS COMPLIANCE

- UPC/cUPC compliant
- **ADA**  **COMPLIANT**

### IMPORTANT

DO NOT use tape or other adhesives on NativeStone as it may remove the sealer.

Due to the handcrafted nature of this product, it will vary in finish, texture, and other details. Dimensions may vary up to 1/4" (6mm).